

Samuel Beckett Bridge, Dublin, Ireland

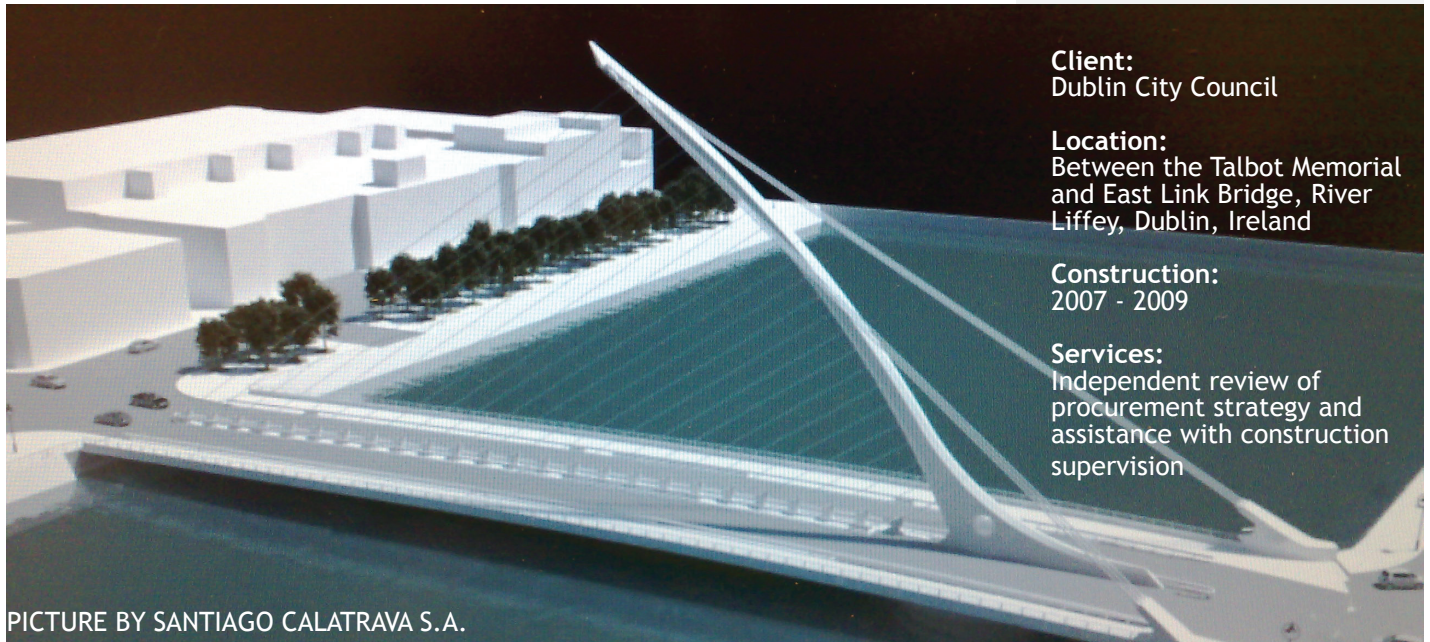

PICTURE BY SANTIAGO CALATRAVA S.A.

Client:
Dublin City Council

Location:
Between the Talbot Memorial
and East Link Bridge, River
Liffey, Dublin, Ireland

Construction:
2007 - 2009

Services:
Independent review of
procurement strategy and
assistance with construction
supervision

The proposed bridge will be a cable stayed structure with a span of 120 metres between the north and south quays and will rotate horizontally about a pivot pier. The cable stayed pylon will have a curved profile leaning northward and rising to a height of 46 metres above the adjacent quays. The bridge deck will be a structural steel box section with side cantilevers supporting the footpath and cycle tracks. The width of the bridge will be 18 metres. The bridge has been designed by Santiago Calatrava in association with Roughan and O'Donovan.

The F&N review team were required to review and report on:

- The strengths and weaknesses of the proposed project procurement strategy and give consideration to suitable alternative forms of contract.
- The constructability of the tender design with particular emphasis on structural steelwork components and welded connection details and their suitability.
- An appropriate construction management organisational structure, integrated with the Client's project team to deliver the project.

Subsequent commissions included assisting Dublin City Council with the review of the tendering documents for the construction contract and ad-hoc advice on procurement matters.

F&N are currently supervising steelwork fabrication at an off-site facility and managing commercial aspects of the Contract.

The bridge is due to open in early 2010.